

**GENERAL NOTES**

1. All work shall be done in conformity with applicable provisions of Standard Specifications for Highway Construction, 1938 Edition, as published by the State Highway Department, and the City Engineer's Office.
2. The contractor shall be responsible for the construction of all work shown on this drawing.
3. The contractor shall be responsible for the construction of all work shown on this drawing.
4. Curb openings for drainage shall be constructed in the field.

APPROVED	1924
CITY ENGINEER	
REGISTERED CIVIL ENGINEER NO.	
DRAWING NO.	3747
CHECKED BY	
RECOMMENDED TO	
SHEETS	1

DEPARTMENT OF ENGINEERING  
CITY OF SAN BERNARDINO  
GENEVIÈVE STREET  
From the North Line of Tract No. 4025 to 235 North

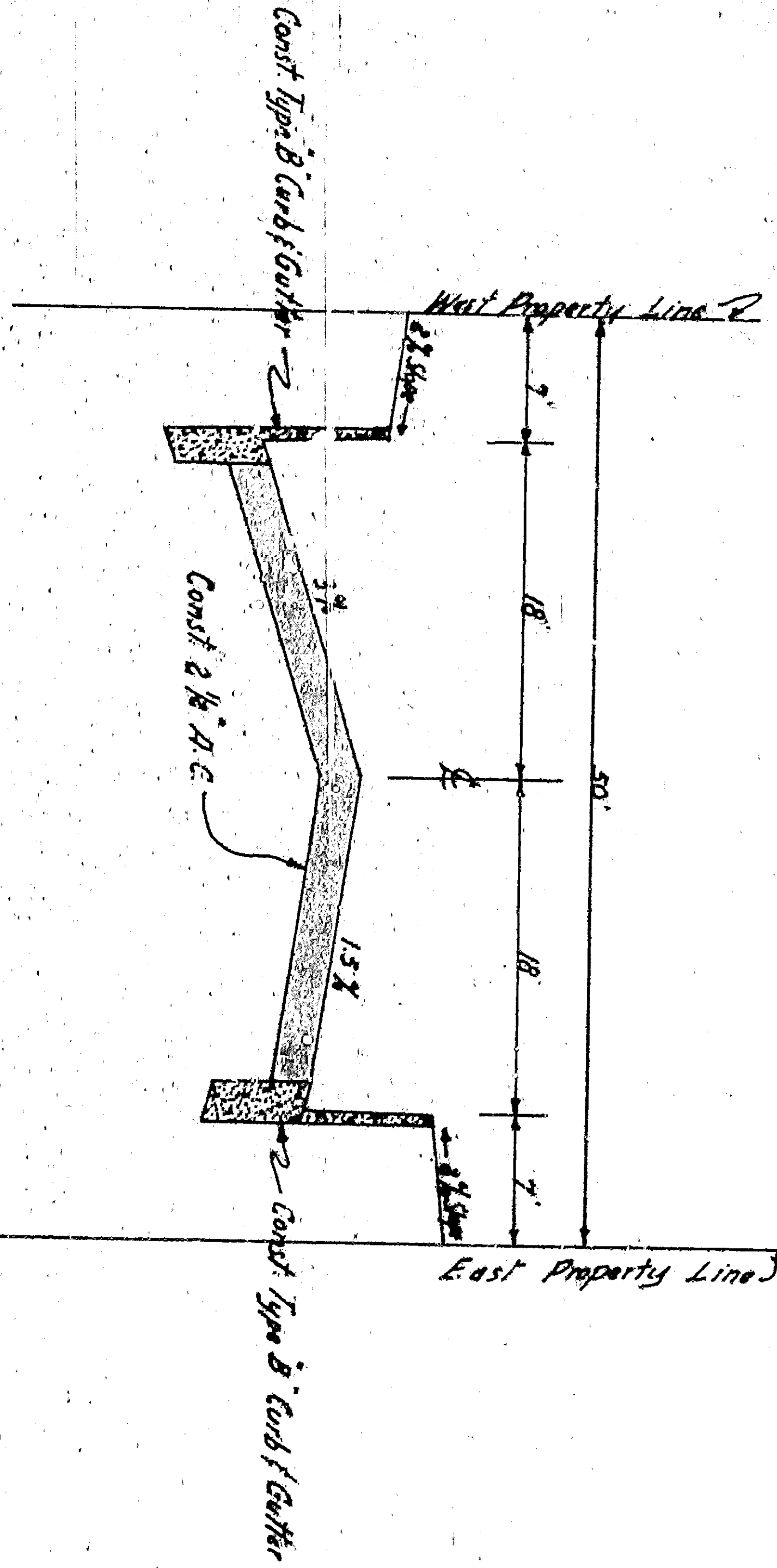


TYPICAL SECTION  
Scale: Horiz. 1"=10'  
Vert. 1"=1'

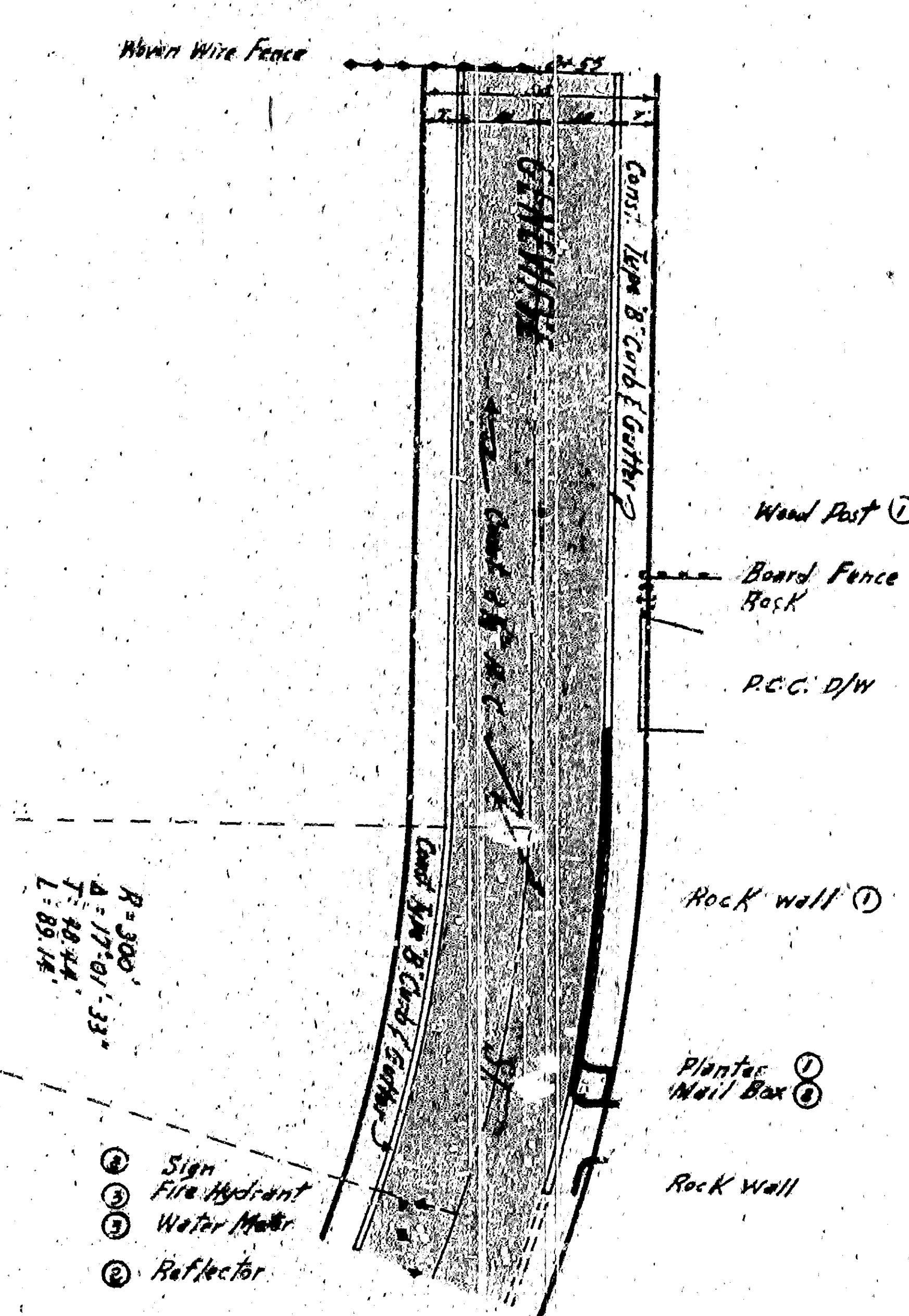
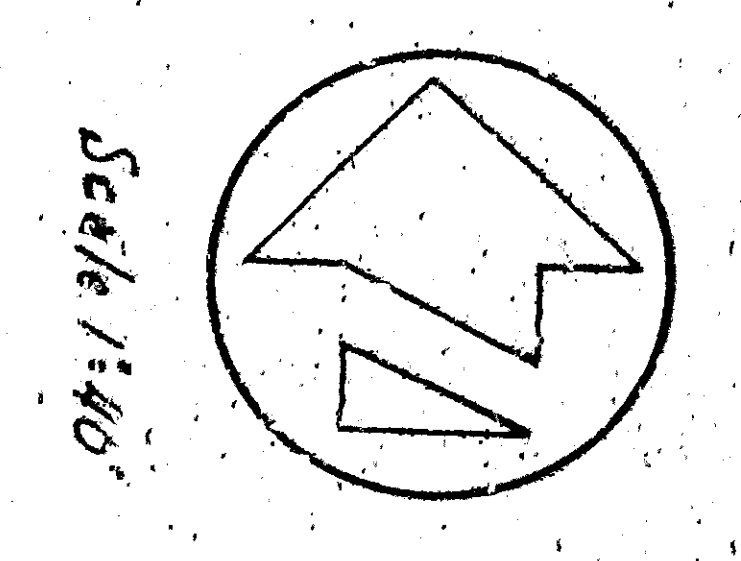

**GENERAL NOTES**

1. All work to be done in accordance with applicable provisions of Standard Specifications for Highway Construction, 1961 Edition, as published by the California State Highway Department.
2. The work shall be completed within the contract period.
3. The work shall be completed by 11:59 P.M. on the date specified in the contract.
4. Construction shall be in accordance with the plans and specifications.

APPROVED	1942
REGISTERED CIVIL ENGINEER NO. 3747	
CITY ENGINEER	
CITY OF SAN BERNARDINO	
CHECKED BY	
RECOMMENDED BY	
SHEET 1 OF 1	
SHEETS	
DEPARTMENT OF ENGINEERING	
CITY OF SAN BERNARDINO	
GENEVIEVE STREET	
From the North Line of Tract No. 4025 to 235' North	